

$$L1 = 2.0 * (\text{No. of pin}) + 0.5$$

$$L2 = 2.0 * (\text{No. of pin} - 1)$$

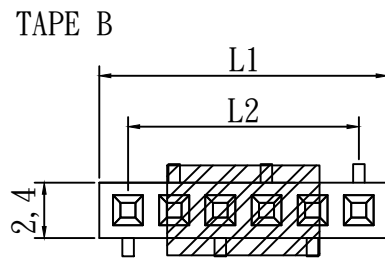

$$L1 = 2.0 * (\text{No. of pin}) + 0.5$$

$$L2 = 2.0 * (\text{No. of pin} - 1)$$

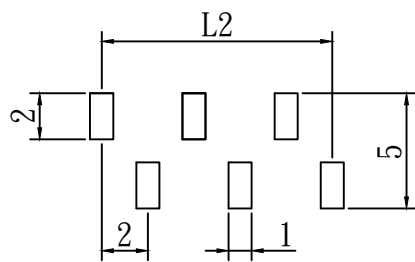
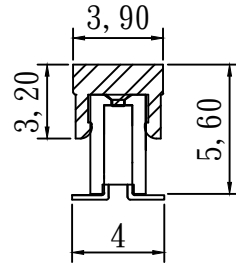
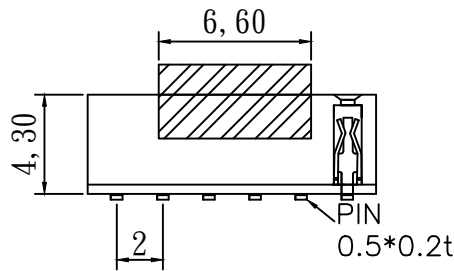

RECOMMENDED P.C.B. LAYOUT(TA)

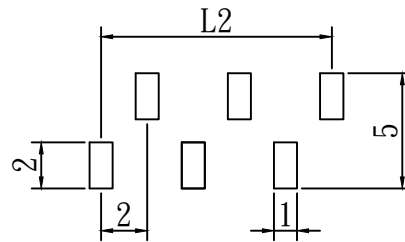

RECOMMENDED P.C.B. LAYOUT(TB)

specifications

current rating:2amp
 voltage rating:200V ac max
 insulator resistance:3000 M ohms min.
 contact resistance:20 m ohms max.
 dielectric withstanding:500v ac for one minute
 operating temperature:-40°C--+105°C(ny6t/ny9t)
 max.processing temp:245±5°C for 3-5seconds(ny6t/ny9t)

contact material:phosphor bronze
 insulator material:nylon6t/nylon9t
 color:black
 finish:gold flash

packing:bag/tube/reel

HOW TO ORDER

HT200F43-x-x-1/2*x-x

Base No

V6:6T
 V9:9T

S: Straight type
 R: Right angle type
 T: SMT

Single row/Dual rows

number of circuit
 02-40

type no.

HTE TECHNOLOGY CO.,LTD
HTE 興田科技有限公司

CUSTOMER APPROVAL				P/N	HT200F43TX-1*X-C			UNIT	mm	SIZE	A4
				TITLE	2.00mm female header single row smt type			GENERAL TOLERANCE 0.=±0.30 0.0=±0.20 0.00=±0.15		SCALE	3:1
	REV.	DESCRIPTION	DATE	DRAWN	LILY	CHECKED	SANDY			SHEET	1/1