

HT3002WTR-X-D

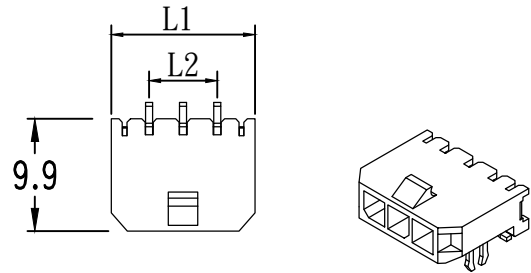

$L1 = 3.0 * (\text{NO. OF PIN}) + 3.65$
 $L2 = 3.0 * (\text{NO. OF PIN} - 1)$

HT3002WTR-X-F

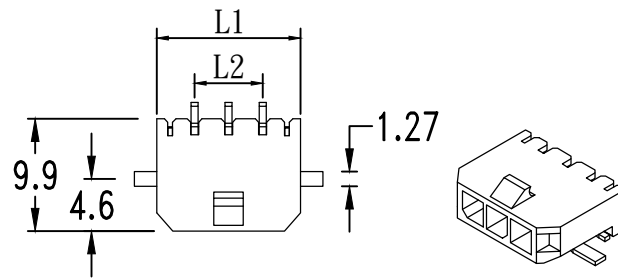

$L1 = 3.0 * (\text{NO. OF PIN}) + 3.65$
 $L2 = 3.0 * (\text{NO. OF PIN} - 1)$

specifications

current rating:5A

voltage rating:250v

contact resistance:10mΩ max

dielectric withstanding:ac 1500v/minute

operating temperature:-25°C--85°C

mates with :HT3002HM-X housing

insulator material:LCP

contact material : BRASS

color:black

finish:120u"tin plated

packing:reel

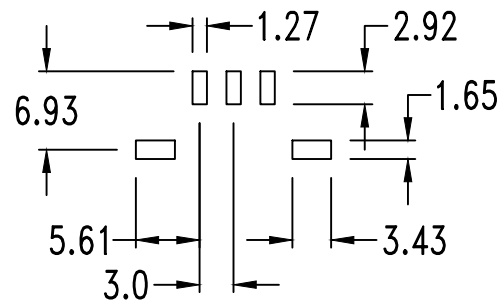
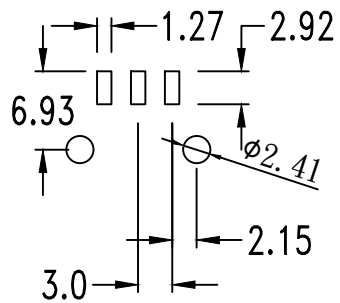
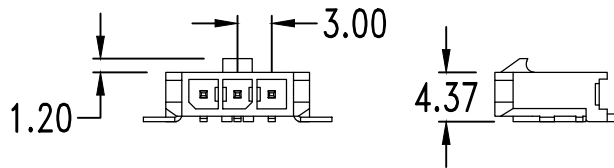
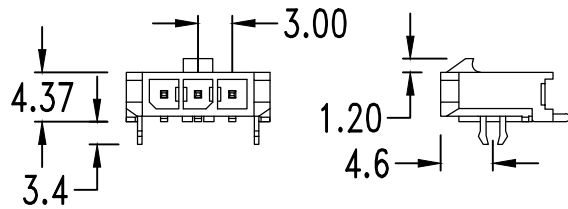

RECOMMENDED P.C.B. LAYOUT

HOW TO ORDER

HT3002WTR-X-D/F

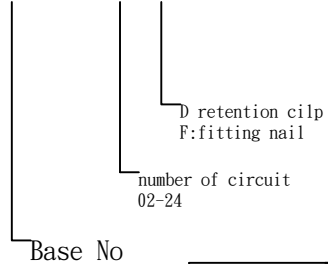

HTE TECHNOLOGY CO.,LTD
HTE 興田科技有限公司

CUSTOMER APPROVAL

P/N

HT3002WTR-X-D/F

UNIT

mm

SIZE

A4

TITLE

3.0mm single row smt
right angle type

GENERAL TOLERANCE
 0.=±0.25
 0.0=±0.15
 0.00=±0.05

SCALE

2:1

REV.

DESCRIPTION

DATE

DRAWN

LILY

CHECKED

SANDY

SHEET

1/1